

NOTE

Diversion to be driven prior to the road closure being installed.

Plans for any road closure should be discussed by the designer with the police and any relevant Highways Authorities If traffic is being diverted on to their network.

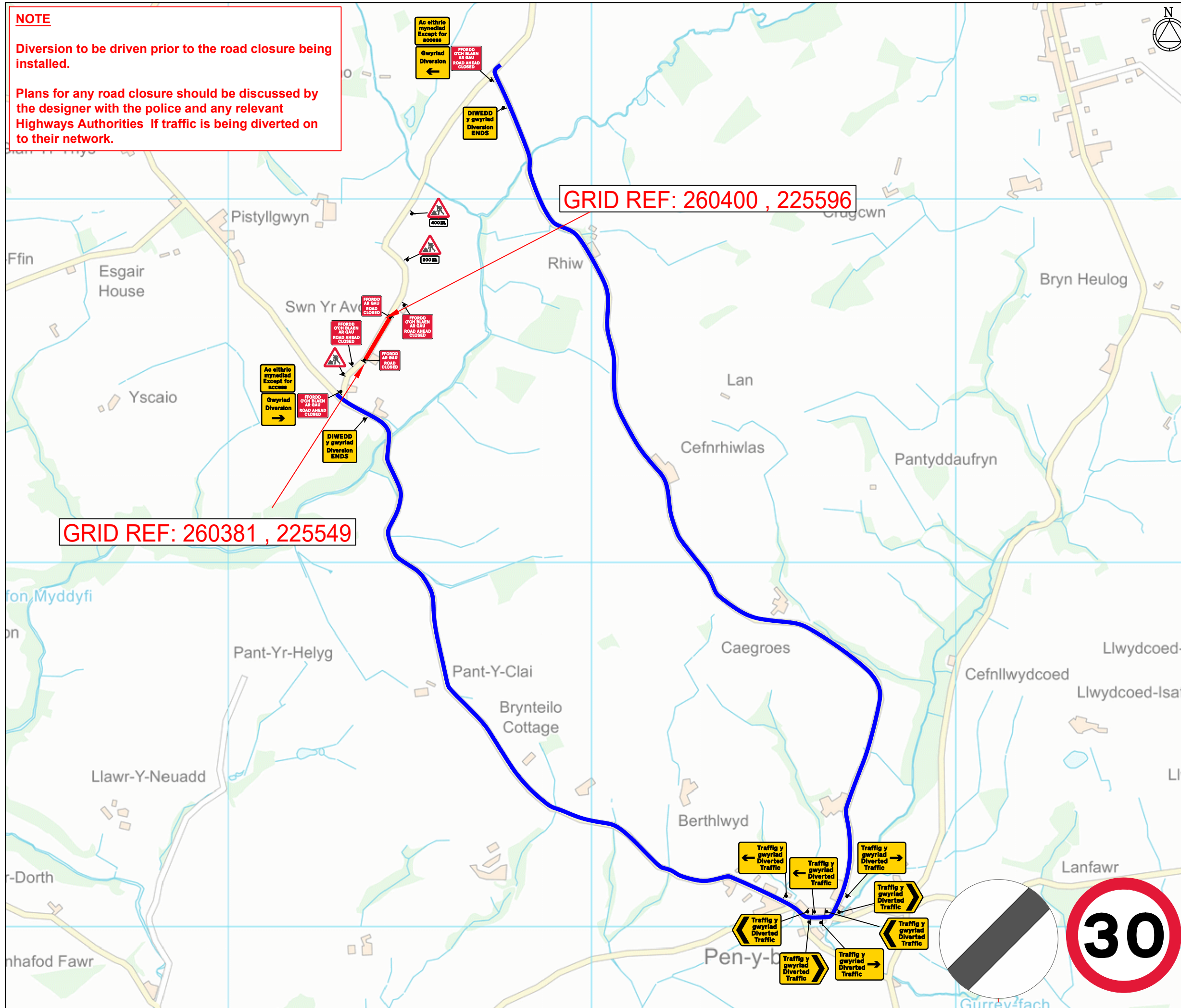

All traffic signs shall comply with Chapter 8 of the Traffic Signs Manual
 Maximum distance between any two temporary traffic signals to be 249m.
 Minimum distance between any two temporary traffic signals to be 30m.
 Temporary traffic signals shall not occur within 150m of an existing level crossing.
 Pedestrian crossing or signalised junction without the consent of the Engineer.
 The Engineer shall consult with the authority responsible for any of these types of facility prior to traffic management being installed in adjacent areas.
 Coning shall be installed at 45° to the edge of carriageway, as generally indicated.

DETAIL B

Single/Dual carriageway 40mph or less - 450mm traffic cones, spacing 1.5m.
 Single/Dual carriageway 50mph or more - 750mm traffic cones, spacing 1.5m.
 Dual carriageway national speed limit - 750mm traffic cones, spacing 1.5m, relaxation 3m.

Notes:
 1) During darkness, warning lights to BS EN 12352:2006 should be provided in accordance with Table A1.3 (Appendix 1).
 2) 45° tapers have 1.5m spacing, no relaxations.
 3) On motorways and NSL AP duals with hard shoulders, 1m cones will be required for both standard and relaxation works for lead tapers and the facing wall of lane changes.

DETAIL C1

Single/Dual carriageway 40mph or less - 450mm traffic cones.
 Single/Dual carriageway 50mph or more - 750mm traffic cones.

Notes:
 1) During darkness, warning lights to BS EN 12352:2006 should be provided in accordance with Table A1.3 (Appendix 1).
 2) For relaxation to Detail C1 see Table A1.3 (Appendix 1).

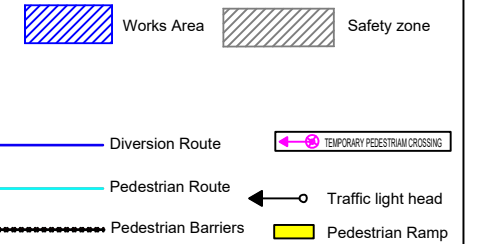

Client

openreach



Works access/ works exit to be risk assessed on site for suitability of location

Project

Manordeilo and Salem, Llandeilo, Carmarthenshire, Wales, SA19

Title

Road closure & diversion



Design: D.MILLS	Drawn: A.GARDNER	Chkd: D.MILLS
Date: 29/10/20	Date: 29/10/20	Date: 29/10/20
Scale: NTS	Status: DRAFT	
Drawing No MJQ2020-2978 - WBLJ9G3S - LLANDEILO - 20342.001		Rev: